

# Farm for Sale

Busey Farm Brokerage



## Farm for Sale

### Don & Joy Morris Farm—Macon County 93.97 acres in Harristown Township

#### Location

This farm is located 1.0 mile Northwest of Harristown Illinois in Harristown Township.

#### Legal Description

The South Half (S ½) of the Northwest Quarter (NW ¼) and the West ten acres of the South Half (S ½) of the Northeast Quarter (NE ¼) Situated in Section Four (S4) Township 16 North (T16N) Range 1 East (R1E) of the Third Principal Meridian in Macon County, Illinois and consisting of 93.97 acres, more or less.

#### Listing Price

**93.97 Acres @ \$ 11,250.00/acre = \$ 1,057,162.50**

#### Lease/Possession

The lease for this farm is currently open for 2018.

#### Contact Information



**Corey Zelhart, Listing Broker 217-425-8245**  
**Tom Courson, Broker 217-425-8291**  
**Dean Kyburz, Broker 217-425-8290**  
**Nick Suess, Broker 217-425-8296**  
**Steve Myers, Managing Broker 217-425-8340**

[busey.com](http://busey.com)

259 E. South Park—Decatur, IL 62523  
Phone: 217-425-8340—Fax 217-362-2724

#### Macon County FSA Data

<b>Farm #</b>	6035	<b>Tract #</b>	2467
<b>Total Acres:</b>	94.0	<b>Cropland Acres:</b>	94.0
<b>Corn Base Acres:</b>	94.0	<b>Soy Base Acres:</b>	0.0

**Farm Program:** ARC-County

#### Price Loss Coverage (PLC) Yields

<b>Corn Yield:</b>	167	<b>Soybean Yield:</b>	N/A
--------------------	-----	-----------------------	-----

#### Real Estate Tax Information

Parcel ID #	Acres	2017 Assessed Value	2016 Taxes Payable 2017
06-11-04-100-005	90.02	\$ 56,760.00	\$ 4,527.04

#### Yield History

	Corn	Soybeans
<b>2017</b>	NA	75.0
<b>2016</b>	232.0	NA
<b>2015</b>	NA	69.0
<b>2014</b>	236.0	NA
<b>2013</b>	NA	60.0

#### 2015 Soil Test Data

<b>pH:</b> 6.3	<b>P1:</b> 61	<b>K:</b> 285
----------------	---------------	---------------

**Disclaimer:** The information contained in this brochure is considered accurate. It is subject to verification and no liability for errors or omissions is assumed. There are no warranties, expressed or implied, as to the information herein contained, and it is recommended that an independent inspection of the property be made by all buyers.

**Agency:** Busey Farm Brokerage, a division of Busey Bank, its agents and representatives, are agents of the Seller

# Farm for Sale

Plat Map

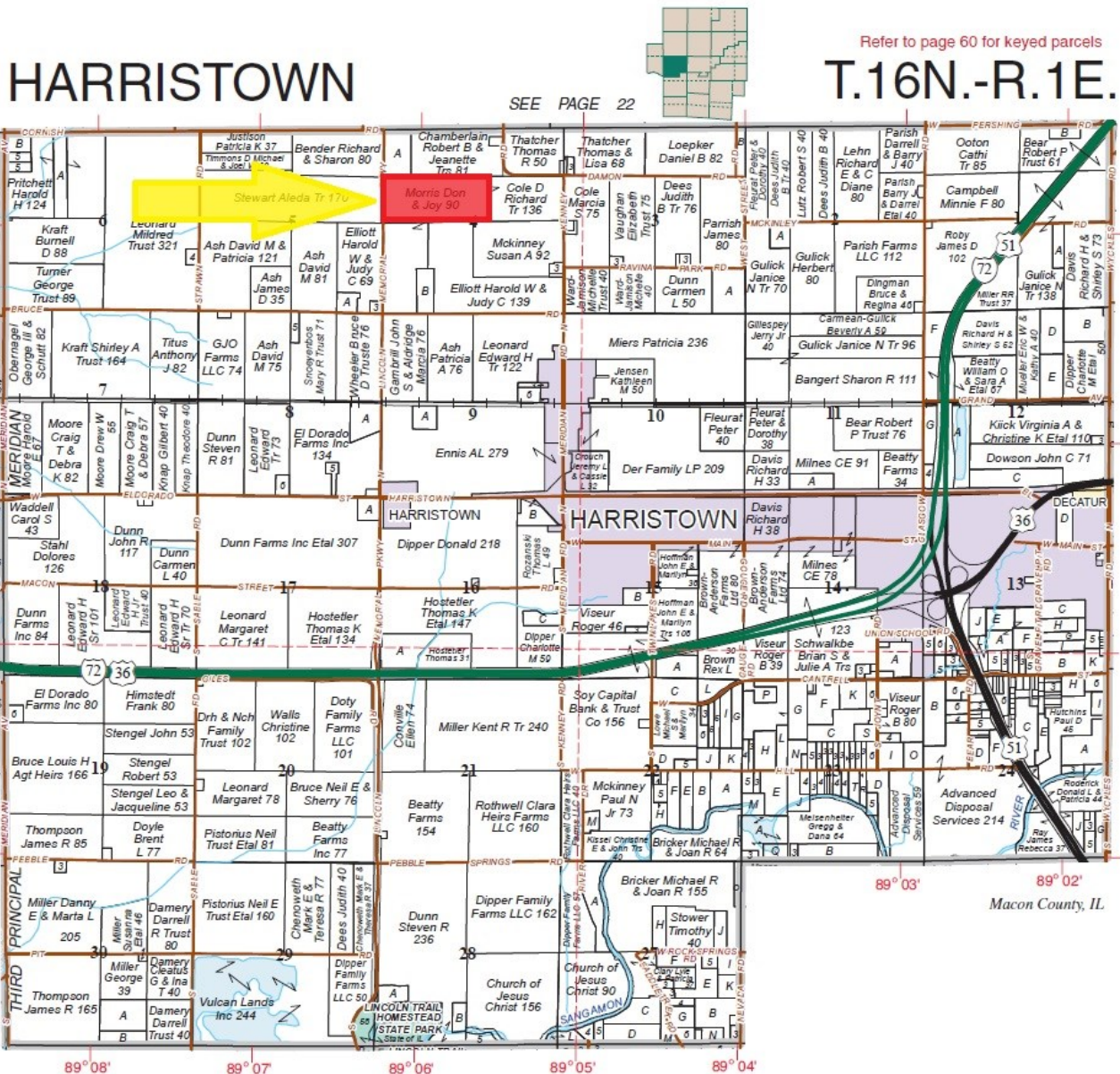

Reprinted with permission of Rockford Map Publishers, Inc.

**Busey** FARM BROKERAGE

Licensed Real Estate Broker Corporation

**Corey Zelhart, Listing Broker**  
**Tom Courson, Broker**  
**Dean Kyburz, Broker**  
**Nick Suess, Broker**  
**Steve Myers, Managing Broker**

**Phone 217-425-8245**  
**Phone 217-425-8291**  
**Phone 217-425-8245**  
**Phone 217-425-8296**  
**Phone 217-425-8340**

**Disclaimer:** The information contained in this brochure is considered accurate. It is subject to verification and no liability for errors or omissions is assumed. There are no warranties, expressed or implied, as to the information herein contained, and it is recommended that an independent inspection of the property be made by all buyers.  
**Agency:** Busey Farm Brokerage, a division of Busey Bank, its agents and representatives, are agents of the Seller

# Farm for Sale

## Aerial Map and Soil Information

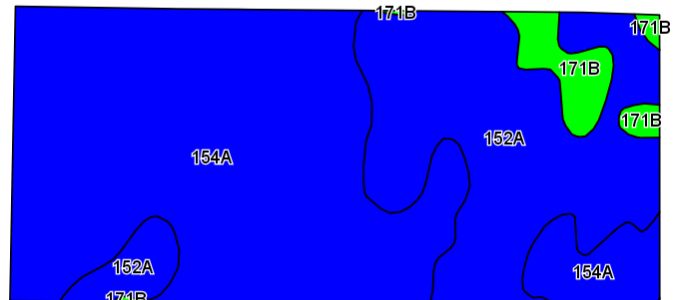

©2017 AgriData, Inc.

Area Symbol: IL115, Soil Area Version: 13							
Code	Soil Description	Acres	Percent of field	Ill. State Productivity Index Legend	Com Bu/A	Soybeans Bu/A	Crop productivity index for optimum management
154A	Flanagan silt loam, 0 to 2 percent slopes	58.15	61.9%		194	63	144
152A	Drummer silty clay loam, 0 to 2 percent slopes	31.74	33.8%		195	63	144
**171B	Catlin silt loam, 2 to 5 percent slopes	4.08	4.3%		**185	**58	**137
<b>Weighted Average</b>					<b>193.9</b>	<b>62.8</b>	<b>143.7</b>



### Licensed Real Estate Broker Corporation

**Corey Zelhart, Listing Broker**  
**Tom Courson, Broker**  
**Dean Kyburz, Broker**  
**Nick Suess, Broker**  
**Steve Myers, Managing Broker**

**Phone 217-425-8245**  
**Phone 217-425-8291**  
**Phone 217-425-8245**  
**Phone 217-425-8296**  
**Phone 217-425-8340**

**Disclaimer:** The information contained in this brochure is considered accurate. It is subject to verification and no liability for errors or omissions is assumed. There are no warranties, expressed or implied, as to the information herein contained, and it is recommended that an independent inspection of the property be made by all buyers.  
**Agency:** Busey Farm Brokerage, a division of Busey Bank, its agents and representatives, are agents of the Seller