

Farm for Sale

Busey Farm Brokerage



Farm for Sale

May Farm—Macon County 17.4 acres in Whitmore Township

Location

This farm is located approximately 1/2 mile north of Oreana in Whitmore Township on Jordan Road.

Legal Description

Part of the East 1/2 of the Northwest 1/4 of the Northeast 1/4 in Section 9, Township 17 North, Range 3 East of the 3rd Principal Meridian, Macon County, IL—Consisting of 17.0 acres more or less.

Listing Price

17.4 acres @ \$9,000/acre = \$156,600.00

Lease/Possession

The lease is open for 2017.

Contact Information



Dean Kyburz, Managing Broker 217-425-8290
Tom Courson, Listing Broker 217-425-8291
Kyle Ogden, Broker 217-425-8279
Corey Zelhart, Broker 217-425-4245

busey.com

259 E. South Park—Decatur, IL 62523
Phone: 217-425-8340—Fax 217-362-2724

County FSA Data

Farm #	5879	Tract #	6412
---------------	------	----------------	------

Total Acres:	17.20	Cropland Acres:	17.20
---------------------	-------	------------------------	-------

Corn Base Acres:	8.80	Soybean Base Acres:	8.40
-------------------------	------	----------------------------	------

Farm Program:	ARC-County
----------------------	------------

Price Loss Coverage (PLC) Yields

Corn Yield:	159	Soybean Yield:	49
--------------------	-----	-----------------------	----

Real Estate Tax Information

Parcel ID #	Acres	2015 Assessed Value	2015 Taxes Payable 2016
18-08-09-200-015	17.4	\$6012.00	\$470.46

Yield Information

2014—Corn 239.02 bu/ac	2013—Soybeans 57.8 bu/ac
2016—Corn 239.01 bu/ac	2015—Soybeans 53.5 bu/ac

Disclaimer: The information contained in this brochure is considered accurate. It is subject to verification and no liability for errors or omissions is assumed. There are no warranties, expressed or implied, as to the information herein contained, and it is recommended that an independent inspection of the property be made by all buyers.
Agency: Busey Farm Brokerage, a division of Busey Bank, its agents and representatives, are agents of the Seller

Farm for Sale

Plat Map

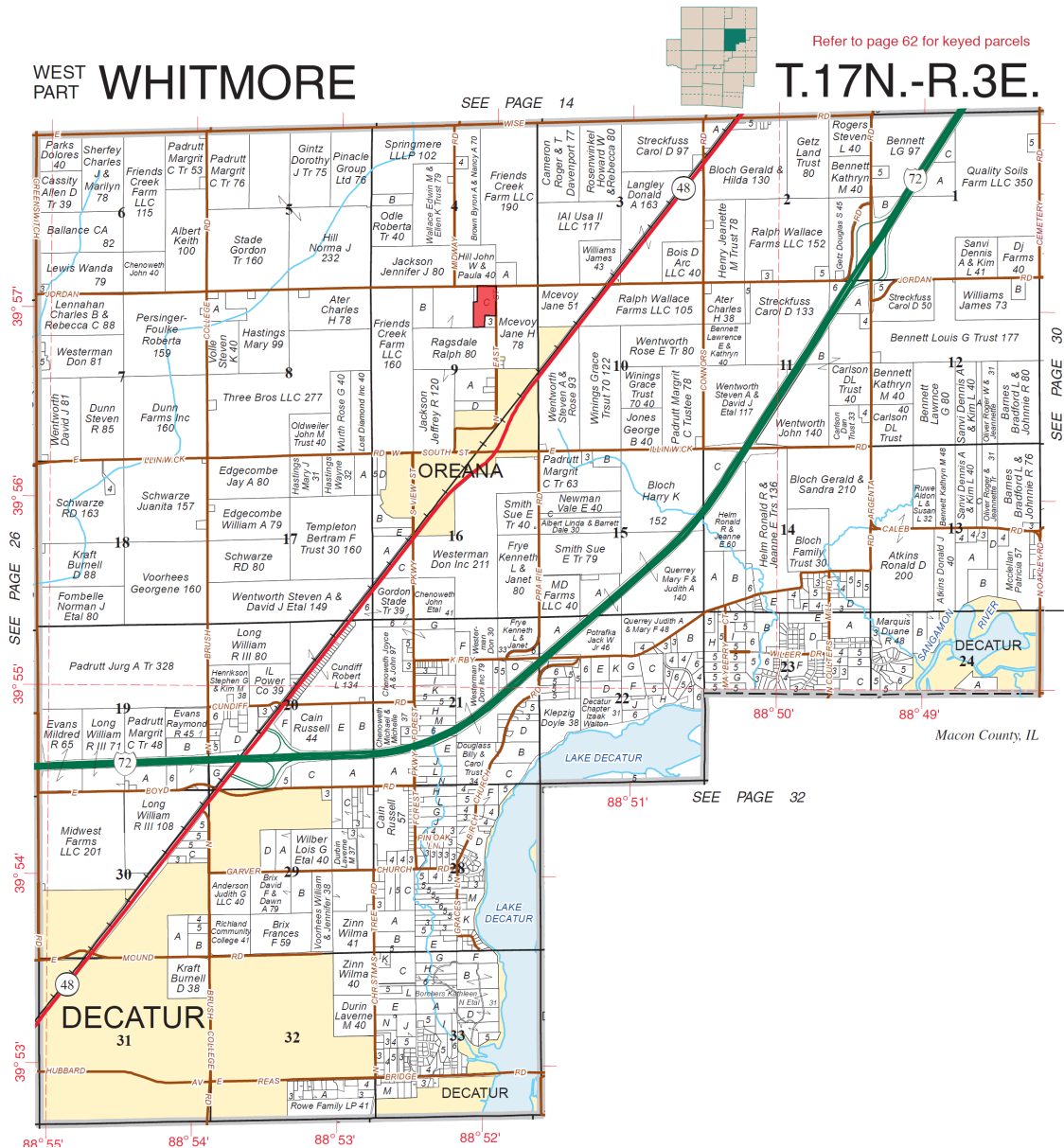

Reprinted with permission of Rockford Map Publishers, Inc.

Busey FARM
BROKERAGE

Licensed Real Estate Broker Corporation

Dean Kyburz, Managing Broker
Kyle Ogden, Listing Broker
Tom Courson, Broker
Corey Zelhart, Broker
Nick Suess, Broker

Phone 217-425-8290
Phone 217-425-8279
Phone 217-425-8291
Phone 217-425-8245
Phone 217-425-8296

Disclaimer: The information contained in this brochure is considered accurate. It is subject to verification and no liability for errors or omissions is assumed. There are no warranties, expressed or implied, as to the information herein contained, and it is recommended that an independent inspection of the property be made by all buyers.
Agency: Busey Farm Brokerage, a division of Busey Bank, its agents and representatives, are agents of the Seller

Farm for Sale

Aerial Map and Soil Information

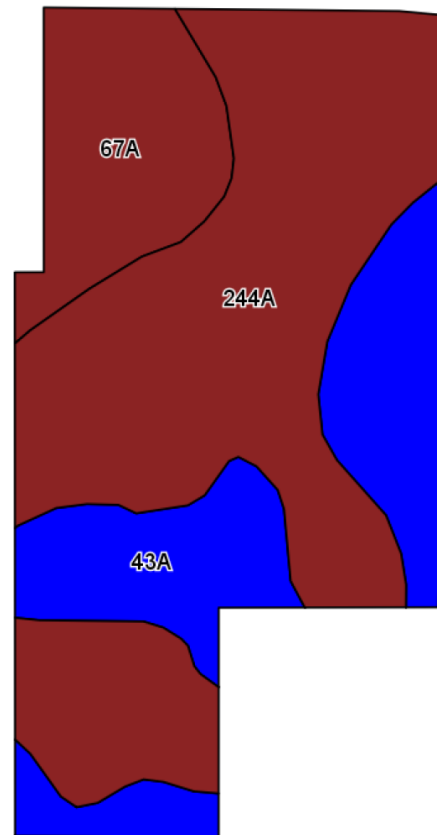
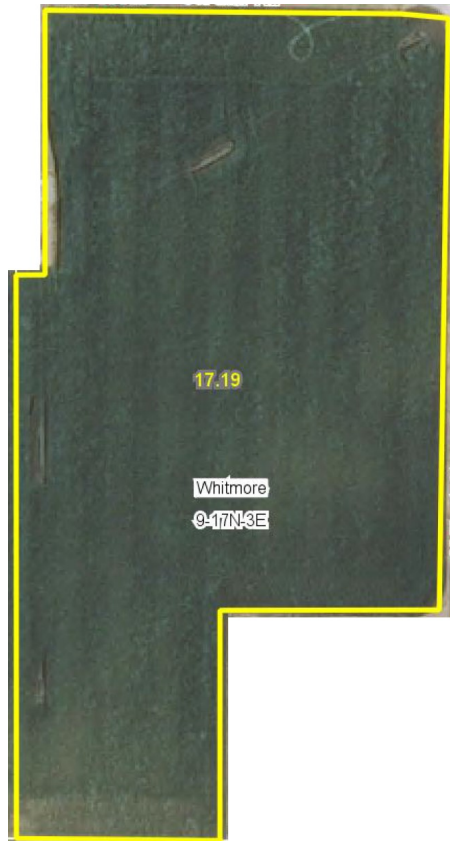

Soil Code	Soil Description	Acres	Percent Tillable	Corn Bu/A	Soybean Bu/A	Crop Productivity Index for optimum management
244A	Hartsburg Silty Clay Loam	9.92	57.7%	182	59	134
43A	Ipava Silt Loam	4.57	26.6%	191	62	142
67A	Harpster Silty Clay Loam	2.70	15.7%	182	57	133
Weighted Average		17.19		184.4	59.5	136



Licensed Real Estate Broker Corporation

Dean Kyburz, Managing Broker
Kyle Ogden, Listing Broker
Tom Courson, Broker
Corey Zelhart, Broker
Nick Suess, Broker

Phone 217-425-8290
Phone 217-425-8279
Phone 217-425-8291
Phone 217-425-8245
Phone 217-425-8296

Disclaimer: The information contained in this brochure is considered accurate. It is subject to verification and no liability for errors or omissions is assumed. There are no warranties, expressed or implied, as to the information herein contained, and it is recommended that an independent inspection of the property be made by all buyers.
Agency: Busey Farm Brokerage, a division of Busey Bank, its agents and representatives, are agents of the Seller