

Farm for Sale

Busey Farm Brokerage



Farm for Sale

Elmer Brelsfoard Trust Farm 160.00 acres

Location

This farm is located approximately 3 miles southwest of Maroa in Maroa Township.

Legal Description

The East One-Half (E ½) of the North East Quarter (NE ¼) and the North One-Half (N ½) of the South East Quarter (SE ¼) of Section 20, Township Eighteen North (18N), Range Two East (2E), of the Third Principal Meridian (3PM), Macon County, Illinois.

Listing Price

160.0 acres x \$11,000/acre = \$1,760,000.00

Lease/Possession

The farm is currently leased for the 2016 crop year on a 50/50 basis. The seller will retain all rights to the 2016 crop.

Contact Information



Dean Kyburz, Managing Broker 217-425-8290
Tom Courson, Listing Broker 217-425-8291
Kyle Ogden, Broker 217-425-8279
Corey Zelhart, Broker 217-425-4245
Nick Suess, Broker 217-425-8296

busey.com

259 E. South Park—Decatur, IL 62523
Phone: 217-425-8340—Fax 217-362-2724

County FSA Data

Farm #	1149	Tract #	297
--------	------	---------	-----

Total Acres:	156.87	Cropland Acres:	155.46
--------------	--------	-----------------	--------

Corn Base Acres:	77.80	Soybean Base Acres:	77.30
------------------	-------	---------------------	-------

Farm Program:	ARC-County
---------------	------------

Price Loss Coverage (PLC) Yields

Corn Yield:	152	Soybean Yield:	48
-------------	-----	----------------	----

Real Estate Tax Information

Parcel ID #	Acres	2015 Assessed Value	2015 Taxes Payable 2016
10-02-20-400-003	160.00	68,509	\$5,213.76

Soil Test Results

Soil Test		
pH: 6.6	P1: 82	K: 369

Disclaimer: The information contained in this brochure is considered accurate. It is subject to verification and no liability for errors or omissions is assumed. There are no warranties, expressed or implied, as to the information herein contained, and it is recommended that an independent inspection of the property be made by all buyers.
Agency: Busey Farm Brokerage, a division of Busey Bank, its agents and representatives, are agents of the Seller

Farm for Sale

Plat Map

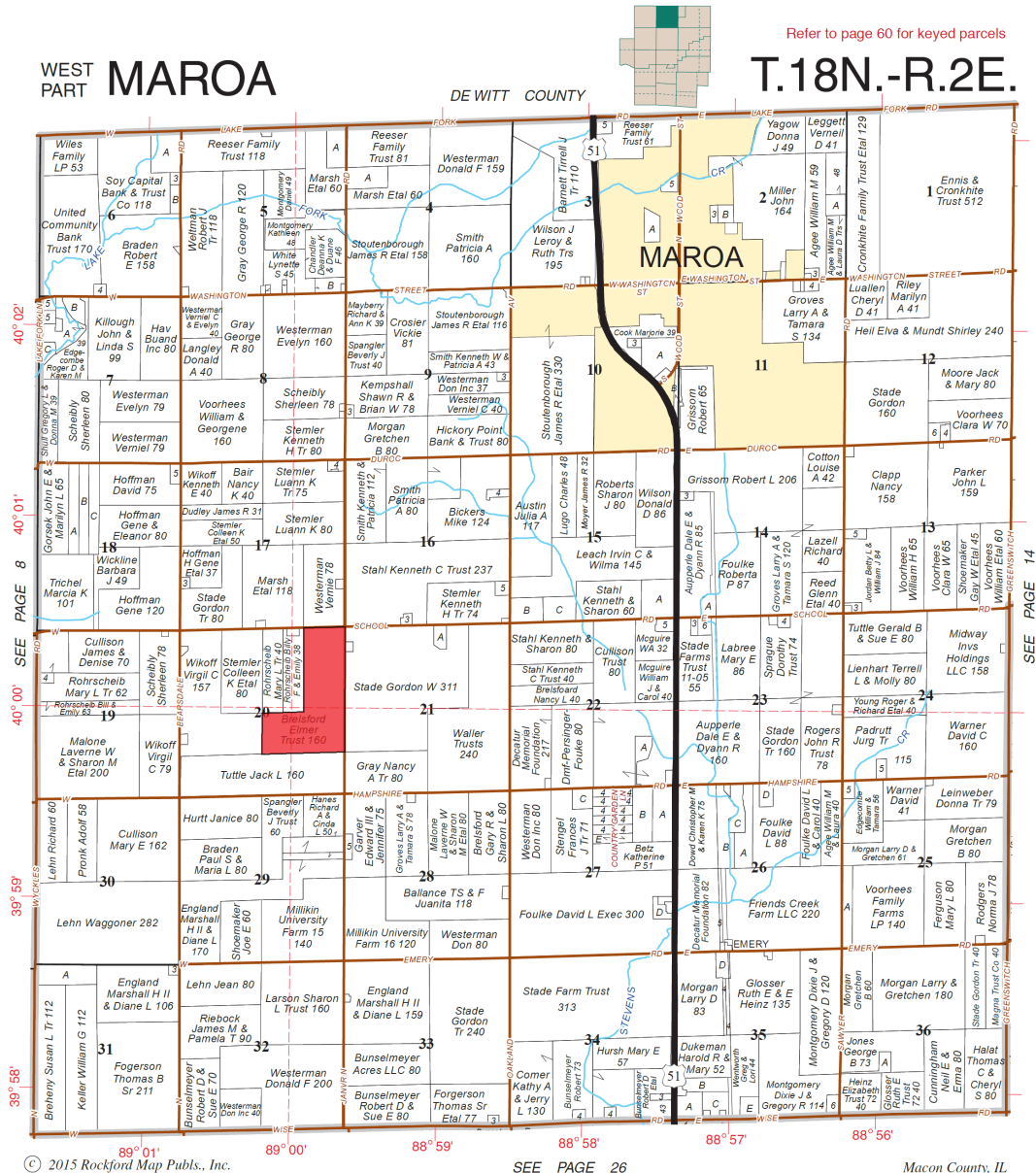

Reprinted with permission of Rockford Map Publishers, Inc.

Busey FARM BROKERAGE

Licensed Real Estate Broker Corporation

Dean Kyburz, Managing/Listing Broker
Tom Courson, Broker
Kyle Ogden, Broker
Corey Zelhart, Broker
Nick Suess, Broker

Phone 217-425-8290
Phone 217-425-8291
Phone 217-425-8279
Phone 217-425-8245
Phone 217-425-8296

Disclaimer: The information contained in this brochure is considered accurate. It is subject to verification and no liability for errors or omissions is assumed. There are no warranties, expressed or implied, as to the information herein contained, and it is recommended that an independent inspection of the property be made by all buyers.
Agency: Busey Farm Brokerage, a division of Busey Bank, its agents and representatives, are agents of the Seller

Farm for Sale

Aerial Map and Soil Information

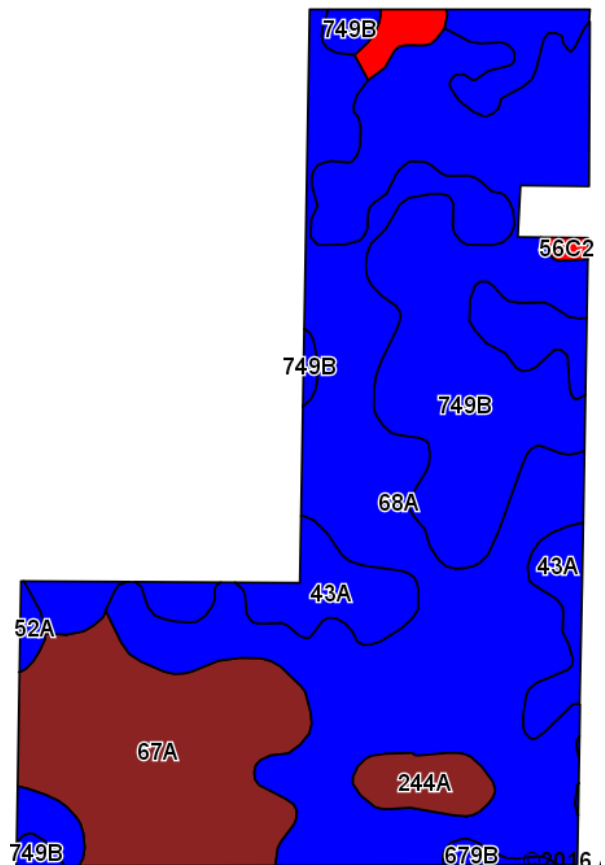
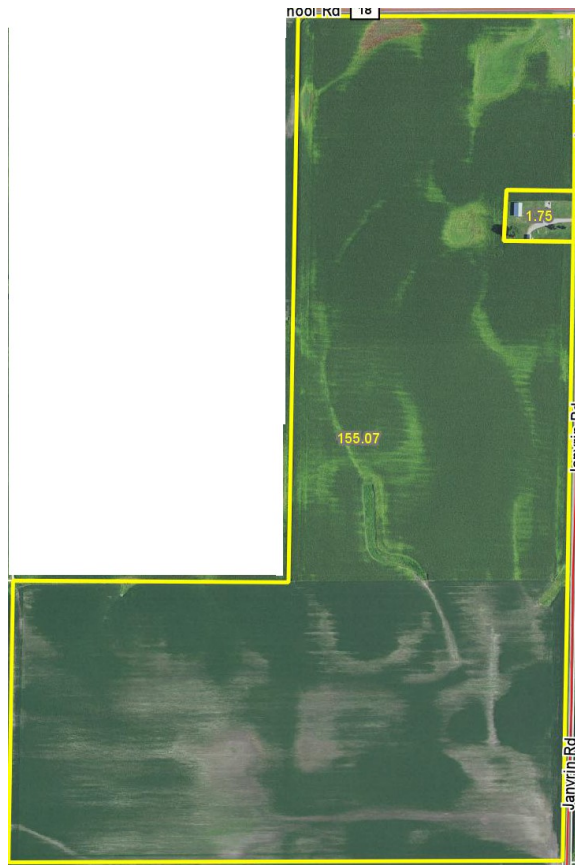

Soil Code	Soil Description	Acres	Percent Tillable	Corn Bu/A	Soybean Bu/A	Crop Productivity Index for optimum management
68A	Sable Silty Clay Loam	69.06	44.5%	192	63	143
749B	Buckhart Silt Loam	41.11	26.5%	188	60	141
67A	Harpster Silty Clay Loam	25.96	16.7%	182	57	133
43A	Ipava Silt Loam	11.90	7.7%	191	62	142
244A	Hartsburg Silty Clay Loam	3.50	2.3%	182	59	134
330A	Peotone Silty Clay Loam	1.60	1.0%	164	55	123
679B	Blackberry Silt Loam	0.75	0.5%	192	59	141
152A	Drummer Silty Clay Loam	0.74	0.5%	195	68	144
56C2	Dana Silty Clay Loam	0.45	0.3%	167	52	122
	Building Site	1.75				
Weighted Average		156.82		188.6	60.9	140.2

Busey FARM BROKERAGE

Licensed Real Estate Broker Corporation

Dean Kyburz, Managing/Listing Broker
Tom Courson, Broker
Kyle Ogden, Broker
Corey Zelhart, Broker
Nick Suess, Broker

Phone 217-425-8290
Phone 217-425-8291
Phone 217-425-8279
Phone 217-425-8245
Phone 217-425-8296

Disclaimer: The information contained in this brochure is considered accurate. It is subject to verification and no liability for errors or omissions is assumed. There are no warranties, expressed or implied, as to the information herein contained, and it is recommended that an independent inspection of the property be made by all buyers.
Agency: Busey Farm Brokerage, a division of Busey Bank, its agents and representatives, are agents of the Seller