

Farm for Sale

Busey Farm Brokerage



Farm for Sale — Development Potential

Fields Crossing Springfield, LLC Farm - Sangamon County 57.59 Acres in Rochester Township

Location

Located between Rochester and Springfield. East of Highlander Estates Subdivision and between IL route 29 and Rochester Rd.

Legal Description (abbreviated)

The S 610 Feet of the W $\frac{1}{2}$ of the SW $\frac{1}{4}$ of Section 8 and part of the W $\frac{1}{2}$ of the SW $\frac{1}{4}$ of Section 8 all in Township 15 N, Range 4 W of the $\frac{1}{3}$ Principal Meridian, Rochester Township, Sangamon County, Illinois.

Listing Price

**57.59 acres x \$10,000.00/acre
\$575,900.00 in Total**

Lease/Possession

Lease is open for 2020

Contact Information



Tom Courson, Listing Broker 217-425-8291

Corey Zelhart, Broker 217-425-4245

Nick Suess, Broker 217-425-8296

Hans Carmien, Broker 217-425-8279

Steve Myers, Managing Broker 309-962-2311

busey.com

259 E. South Park—Decatur, IL 62523
Phone: 217-425-8340—Fax 217-362-2724

County FSA Data

Farm #	5420	Tract #	4346
Total Acres:	57.59	Cropland Acres:	49.27
Corn Base Acres:	3.00	Soybean Base Acres:	7.20
Farm Program:	ARC-County		

Price Loss Coverage (PLC) Yields

Corn Yield:	114	Soybean Yield:	28
-------------	-----	----------------	----

Real Estate Tax Information

Parcel ID #	Acres	2018 Assessed Value	2018 Taxes Payable 2019
23-08.0-300-005	17.47	\$5,767	\$423.22
23-08.0-300-008	40.12	\$15,933	\$1,169.28

Yield Results

Year	Corn Yield	Soybean Yield
2019	170.44	

2013 Soil Test Info

pH: 7.1	P1: 108	K: 716
---------	---------	--------

Disclaimer: The information contained in this brochure is considered accurate. It is subject to verification and no liability for errors or omissions is assumed. There are no warranties, expressed or implied, as to the information herein contained, and it is recommended that an independent inspection of the property be made by all buyers.
Agency: Busey Farm Brokerage, a division of Busey Bank, its agents and representatives, are agents of the Seller

Farm for Sale

Plat Map—Rochester Township

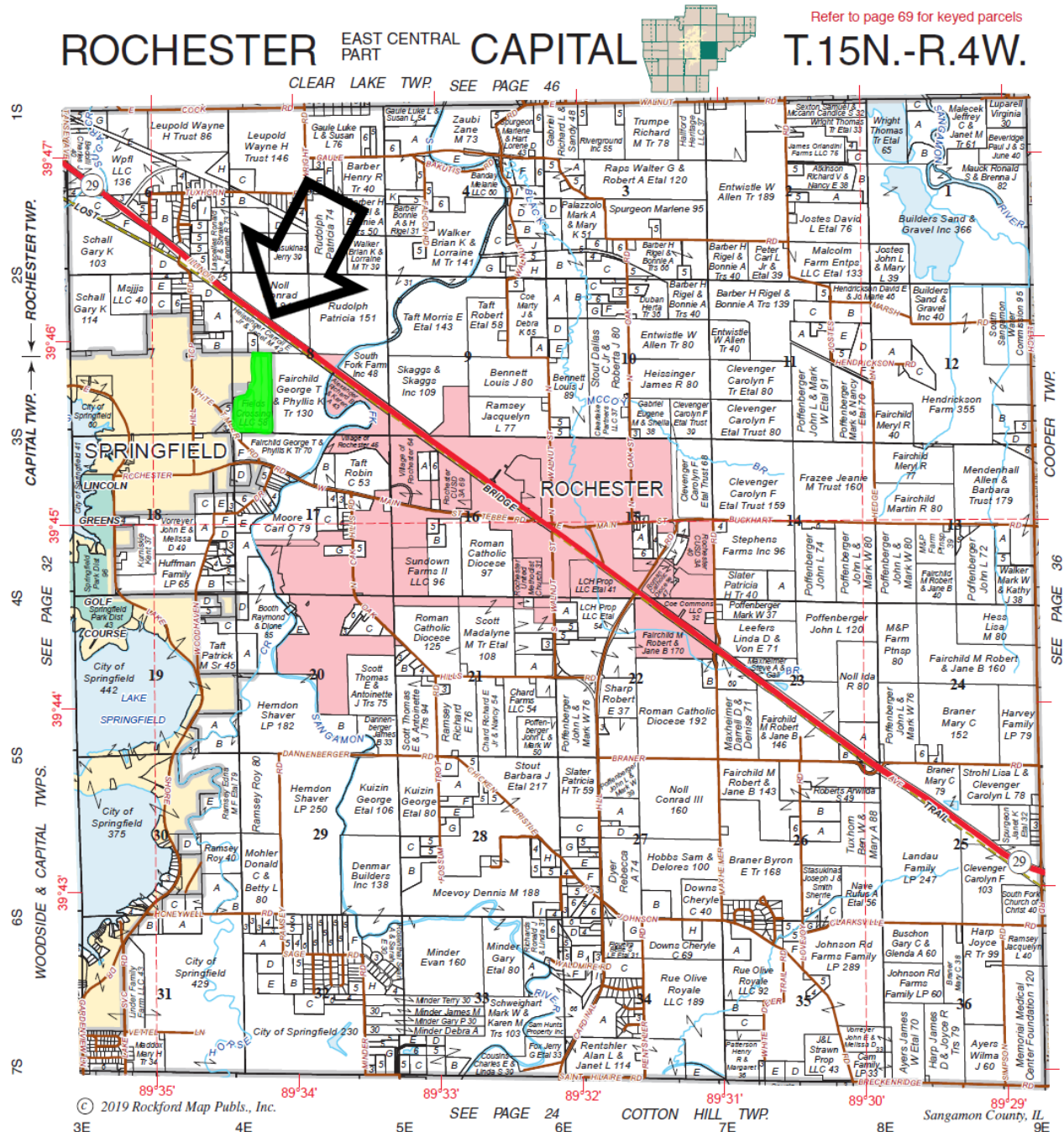

Licensed Real Estate Broker Corporation

Tom Courson, Listing Broker
Hans Carmien, Broker
Corey Zelhart, Broker
Nick Suess, Broker
Steve Myers, Managing Broker

Phone 217-425-8291
Phone 217-425-8279
Phone 217-425-8245
Phone 217-425-8296
Phone 309-962-2311

Disclaimer: The information contained in this brochure is considered accurate. It is subject to verification and no liability for errors or omissions is assumed. There are no warranties, expressed or implied, as to the information herein contained, and it is recommended that an independent inspection of the property be made by all buyers.
Agency: Bussey Farm Brokerage, a division of Bussey Bank, its agents and representatives, are agents of the Seller

Farm for Sale

Aerial Map and Soil Information

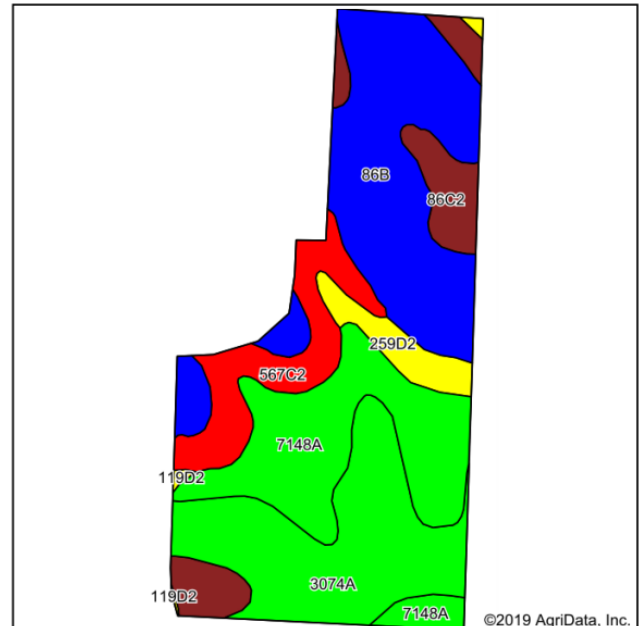

Area Symbol: IL 167, Soil Area Version: 12							
Code	Soil Description	Acres	Percent of field	Il. State Productivity Index Legend	Corn Bu/A	Soybeans Bu/A	Crop productivity index for optimum management
**86B	Osco silt loam, 2 to 5 percent slopes	17.26	29.8%		**189	**59	**140
3074A	Radford silt loam, 0 to 2 percent slopes, frequently flooded	13.81	23.8%		186	58	136
7148A	Proctor silt loam, 0 to 2 percent slopes, rarely flooded	12.99	22.4%		185	58	135
**567C2	Elkhart silt loam, 5 to 10 percent slopes, eroded	6.14	10.6%		**159	**50	**116
**86C2	Osco silt loam, 5 to 10 percent slopes, eroded	3.51	6.1%		**178	**56	**131
**259D2	Assumption silt loam, 10 to 18 percent slopes, eroded	2.46	4.2%		**145	**46	**106
3284A	Tice silty clay loam, 0 to 2 percent slopes, frequently flooded	1.65	2.8%		184	57	134
**119D2	Elco silt loam, 10 to 18 percent slopes, eroded	0.13	0.2%		**134	**44	**100
Weighted Average					181.4	56.8	133.1

Table: Optimum Crop Productivity Ratings for Illinois Soil by K.R. Olson and J.M. Lang, Office of Research, ACES, University of Illinois at Champaign-Urbana. Version: 1/2/2012 Amended Table S2 B811

Crop yields and productivity indices for optimum management (B811) are maintained at the following NRES web site: <http://soilproductivity.nres.illinois.edu/>

** Indexes adjusted for slope and erosion according to Bulletin 811 Table S3

*c: Using Capabilities Class Dominant Condition Aggregation Method

Soils data provided by USDA and NRCS. Soils data provided by University of Illinois at Champaign-Urbana.



Licensed Real Estate Broker Corporation

Tom Courson, Listing Broker
Hans Carmien, Broker
Corey Zelhart, Broker
Nick Suess, Broker
Steve Myers, Managing Broker

Phone 217-425-8291
Phone 217-425-8279
Phone 217-425-8245
Phone 217-425-8296
Phone 309-962-2311

Disclaimer: The information contained in this brochure is considered accurate. It is subject to verification and no liability for errors or omissions is assumed. There are no warranties, expressed or implied, as to the information herein contained, and it is recommended that an independent inspection of the property be made by all buyers.
Agency: Busey Farm Brokerage, a division of Busey Bank, its agents and representatives, are agents of the Seller