

# Farm for Sale

Busey Farm Brokerage



## Farm for Sale

### Dough Farms Opportunity Fund I

37.44 acres in Assumption Township, Christian County, Illinois

#### Location

This farm is located about 3 1/2 miles west of Assumption.

#### Legal Description (abbreviated)

Part of the N 1/2 of the N 1/2 of the SW 1/4 in Section 31, Township 13 North, Range 1 East of the 3rd PM, Christian County, Illinois.

#### Listing Price

**37.44 acres x \$10,750/acre = \$402,480**

#### Contact Information



**Steve Myers, Managing Broker 217-425-8340**  
**Kyle Ogden, Listing Broker 217-425-8279**  
**Tom Courson, Listing Broker 217-425-8291**  
**Dean Kyburz, Broker 217-425-8290**  
**Corey Zelhart, Broker 217-425-4245**  
**Nick Suess, Broker 217-425-8296**

[busey.com](http://busey.com)

259 E. South Park—Decatur, IL 62523  
Phone: 217-425-8340—Fax 217-362-2724

#### County FSA Data

Farm #	6090	Tract #	9455
--------	------	---------	------

Total Acres:	37.06	Cropland Acres:	37.06
--------------	-------	-----------------	-------

Corn Base Acres:	24.90	Soybean Base Acres:	9.00
------------------	-------	---------------------	------

Wheat Base Acres:	2.00	Farm Program—ARC County	
-------------------	------	-------------------------	--

#### Price Loss Coverage (PLC) Yields

Corn Yield:	127	Soybean Yield:	44
-------------	-----	----------------	----

Wheat Yield:	54		
--------------	----	--	--

#### Real Estate Tax Information

Parcel ID #	Acres	2015 Assessed Value	2015 Taxes Payable 2016
01-15-31-300-001-00	37.44	\$9,712	\$741.90

#### Lease/Possession

The farm lease is open for 2017.

**Disclaimer:** The information contained in this brochure is considered accurate. It is subject to verification and no liability for errors or omissions is assumed. There are no warranties, expressed or implied, as to the information herein contained, and it is recommended that an independent inspection of the property be made by all buyers.

**Agency:** Busey Farm Brokerage, a division of Busey Bank, its agents and representatives, are agents of the Seller

# Farm for Sale

## Plat Map

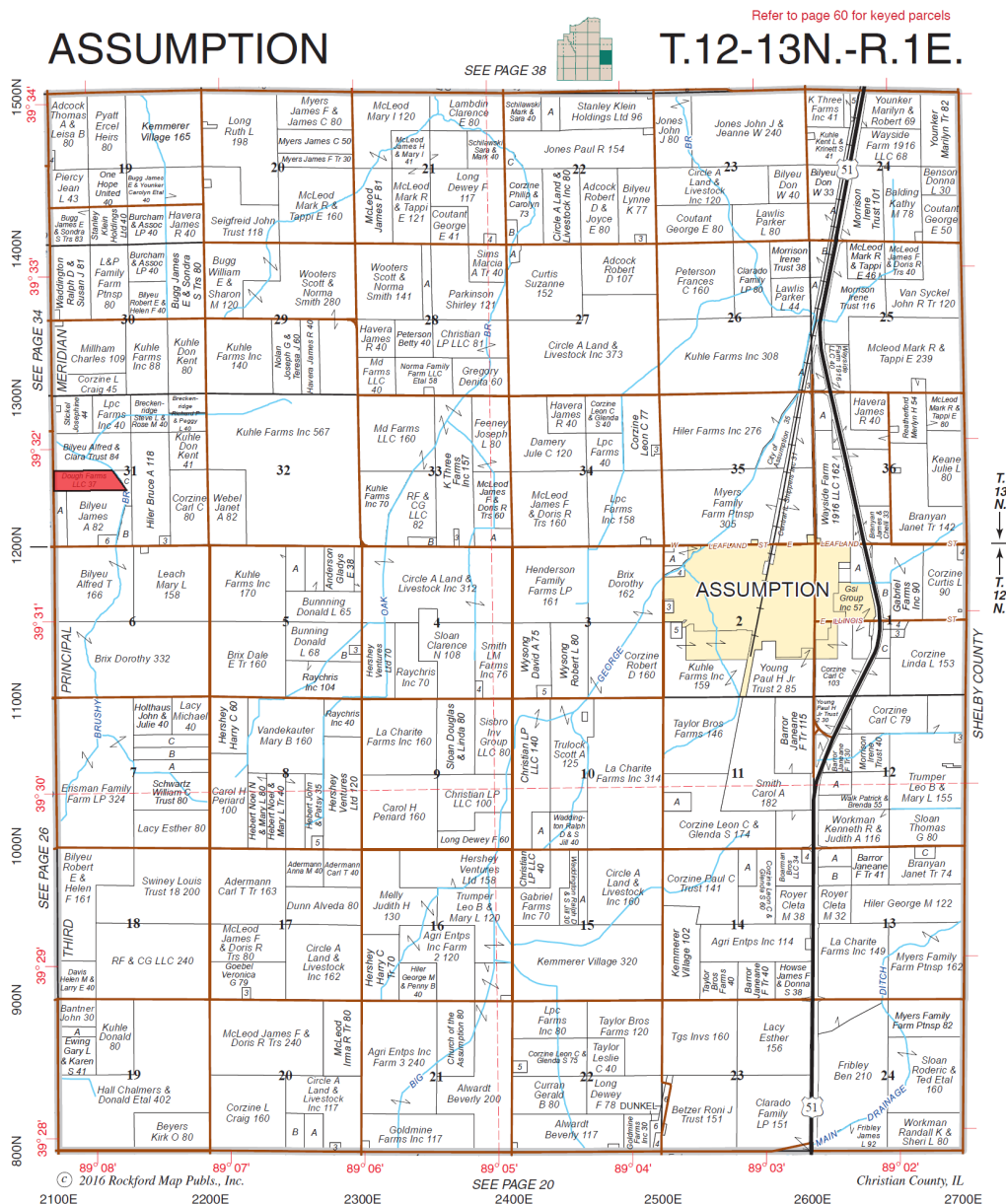

Reprinted with permission of Rockford Map Publishers, Inc.



Licensed Real Estate Broker Corporation

**Steve Myers, Managing Broker**  
**Kyle Ogden, Listing Broker**  
**Tom Courson, Listing Broker**  
**Dean Kyburz, Broker**  
**Corey Zelhart, Broker**  
**Nick Suess, Broker**

**Phone 217-425-8340**  
**Phone 217-425-8279**  
**Phone 217-425-8291**  
**Phone 217-425-8290**  
**Phone 217-425-8245**  
**Phone 217-425-8296**

**Disclaimer:** The information contained in this brochure is considered accurate. It is subject to verification and no liability for errors or omissions is assumed. There are no warranties, expressed or implied, as to the information herein contained, and it is recommended that an independent inspection of the property be made by all buyers.

**Agency:** Busey Farm Brokerage, a division of Busey Bank, its agents and representatives, are agents of the Seller

# Farm for Sale

## Aerial Map and Soil Information

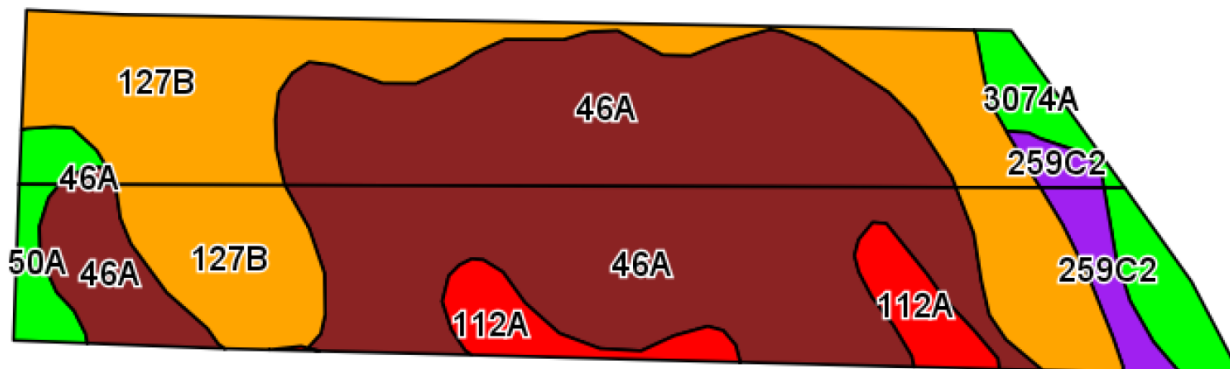

Soil Code	Soil Description	Acres	Percent Tillable	Corn Bu/A	Soybean Bu/A	Crop Productivity Index for optimum management
46A	Herrick Silt Loam	18.91	52.8%	181	58	133
127B	Harrison Silt Loam	11.19	31.2%	177	54	129
112A	Cowden Silt Loam	1.98	5.5%	159	49	117
3074A	Radford Silt Loam	1.75	4.9%	186	58	136
259C2	Assumption Silt Loam	1.05	2.9%	152	48	111
50A	Virden Silty Clay Loam	0.95	2.7%	182	59	135
<b>Weighted Average</b>		<b>35.83</b>		<b>178</b>	<b>56</b>	<b>130.4</b>



**Licensed Real Estate Broker Corporation**

**Steve Myers, Managing Broker**  
**Kyle Ogden, Listing Broker**  
**Tom Courson, Listing Broker**  
**Dean Kyburz, Broker**  
**Corey Zelhart, Broker**  
**Nick Suess, Broker**

**Phone 217-425-8340**  
**Phone 217-425-8279**  
**Phone 217-425-8291**  
**Phone 217-425-8290**  
**Phone 217-425-8245**  
**Phone 217-425-8296**

**Disclaimer:** The information contained in this brochure is considered accurate. It is subject to verification and no liability for errors or omissions is assumed. There are no warranties, expressed or implied, as to the information herein contained, and it is recommended that an independent inspection of the property be made by all buyers.

**Agency:** Busey Farm Brokerage, a division of Busey Bank, its agents and representatives, are agents of the Seller