

Farm for Sale

Busey Farm Brokerage



Farm for Sale

Duane E. and Elizabeth A. Medaris Farm 40.0 acres

Location

This farm is located 3.5 miles southwest of Bement and 4.0 miles north of Hammond in Unity Township.

Legal Description

The West Half (W 1/2) of the West Half (W 1/2) of the Southwest Quarter (SW 1/4) of Section One, Township 16 North, Range 5 East of the Third Principal Meridian in Piatt County, Illinois.

Listing Price

40.0 acres x 10,800.00/acre = \$ 432,000.00

Lease/Possession

The lease for this farm is currently open for 2017.

Contact Information



Corey Zelhart, Listing Broker 217-425-8245
Tom Courson, Broker 217-425-8291
Kyle Ogden, Broker 217-425-8279
Nick Suess, Broker 217-425-8296
Steve Myers, Managing Broker 217-425-8340

busey.com

259 E. South Park—Decatur, IL 62523
Phone: 217-425-8340—Fax 217-362-2724

Piatt County FSA Data

Farm #	5638	Tract #	5127
Total Acres:	39.15	Cropland Acres:	37.67
Corn Base Acres:	18.7	Soy Base Acres	17.9

Farm Program: ARC-County

Price Loss Coverage (PLC) Yields

Corn Yield: 179 Soybean Yield: 53

Real Estate Tax Information

Parcel ID #	Acres	2016 Assessed Value	2015 Taxes Payable 2016
07-01-16-005-005	40.0	\$23,756.00	\$2,048.92

Yield History

	Corn	Soybeans
2016	241.0	NA
2015	NA	78.0
2014	263.0	NA
2013	NA	65.0

Disclaimer: The information contained in this brochure is considered accurate. It is subject to verification and no liability for errors or omissions is assumed. There are no warranties, expressed or implied, as to the information herein contained, and it is recommended that an independent inspection of the property be made by all buyers.

Agency: Busey Farm Brokerage, a division of Busey Bank, its agents and representatives, are agents of the Seller

Farm for Sale

Plat Map

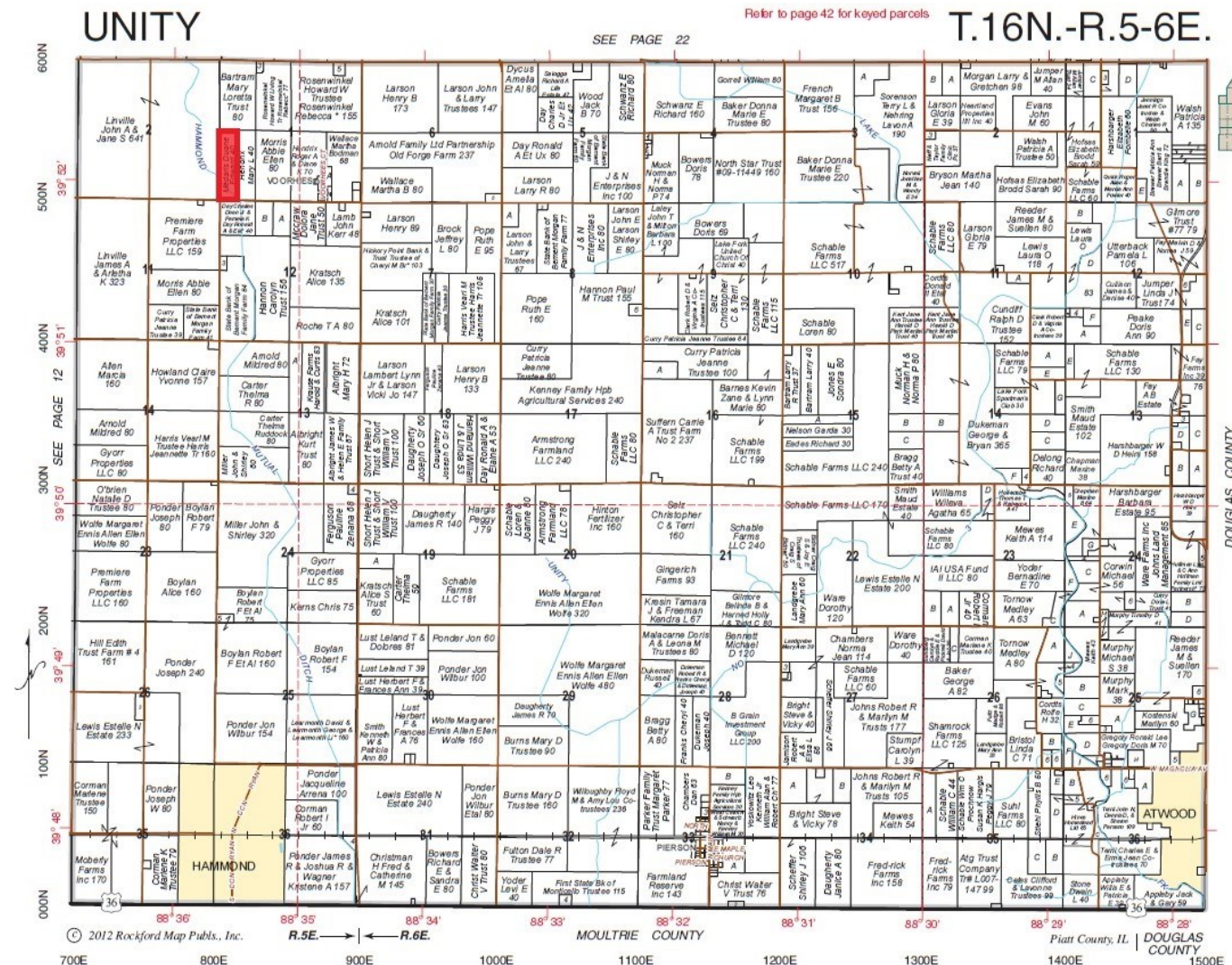

Reprinted with permission of Rockford Map Publishers, Inc.

Busey FARM BROKERAGE

Licensed Real Estate Broker Corporation

Corey Zelhart, Listing Broker
Tom Courson, Broker
Kyle Ogden, Broker
Nick Suess, Broker
Steve Myers, Managing Broker

Phone 217-425-8245
Phone 217-425-8291
Phone 217-425-8279
Phone 217-425-8296
Phone 217-425-8340

Disclaimer: The information contained in this brochure is considered accurate. It is subject to verification and no liability for errors or omissions is assumed. There are no warranties, expressed or implied, as to the information herein contained, and it is recommended that an independent inspection of the property be made by all buyers.
Agency: Busey Farm Brokerage, a division of Busey Bank, its agents and representatives, are agents of the Seller

Farm for Sale

Aerial Map and Soil Information

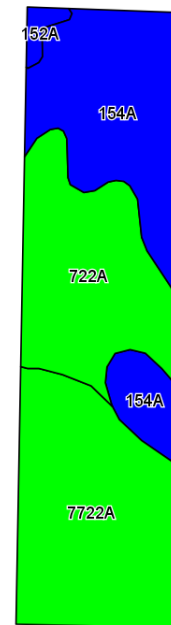

©2016 AgriData, Inc.

Soil Code	Soil Description	Acres	Percent Tillable	Corn Bu/A	Soybean Bu/A	Crop Productivity Index for optimum management
722A	Drummer Milford Silty Clay Loam	14.45	36.1%	184	60	137
154A	Flanagan Silt Loam	13.63	34.1%	194	63	144
722A	Drummer Milford Silty Clay Loam	11.37	28.4%	184	60	137
152A	Drummer Silty Clay Loam	0.55	1.4%	195	63	144
Weighted Average		40.0		187.6	61.1	139.5



Licensed Real Estate Broker Corporation

Corey Zelhart, Listing Broker
Tom Courson, Broker
Kyle Ogden, Broker
Nick Suess, Broker
Steve Myers, Managing Broker

Phone 217-425-8245
Phone 217-425-8291
Phone 217-425-8279
Phone 217-425-8296
Phone 217-425-8340

Disclaimer: The information contained in this brochure is considered accurate. It is subject to verification and no liability for errors or omissions is assumed. There are no warranties, expressed or implied, as to the information herein contained, and it is recommended that an independent inspection of the property be made by all buyers.

Agency: Busey Farm Brokerage, a division of Busey Bank, its agents and representatives, are agents of the Seller